



**TOUGHNESS GUARANTEED**

**BIKE LOCKS 2024**

# THE VERY BEST IN BICYCLE SECURITY DESIGNED FOR EVERY CYCLIST

Squire have been at the forefront of lock making since 1780 with a great British history carried down through an incredible eight generations.

In 1963 Squire launched the first range of cycle locks in the UK. We were ahead of our time and have continued to refine our products using modern innovative technology to create some of the toughest locks available, independently attack tested with proven theft resistance.

We stand by our reputation for long-lasting toughness by offering a personal 10-year guarantee from John Squire on our entire bike lock catalogue.

Choose from our unrivalled selection including **Stronghold**<sup>®</sup> maximum security bike locks, the innovative **Straplok**<sup>™</sup> and **Chainlok**<sup>™</sup> Wearable Bike Locks, heavy-duty Padlock & Chain Sets, D-Locks, compact Folding Locks, key and combination Cable Locks, ultra-light weight Cafe Bike Locks and our **inigma**<sup>™</sup> smart technology range.

Peace of mind At Home or On-The-Go, we've got you covered.



**TOUGHNESS GUARANTEED**

  
**240|YEARS**  
OF LOCKMAKING EXCELLENCE



# ACCREDITATIONS

## **SOLD SECURE**

Sold Secure are the premier British testing and certification body for all security products. Only locks that have been satisfactorily tested are allowed to carry the Sold Secure mark of approval. Squire offer a wide selection of Sold Secure bike locks ranging from Silver to Diamond level security suitable for all budgets.



## **BSI KITEMARK™**

The BSI Kitemark is recognised worldwide as the ultimate mark of quality, safety and trust. Squire are the first organisation to achieve a BSI Kitemark for the internet of Things (Residential) for bike lock. Our **Inigma™** bikelocks carry the IoT certification while our Inigma operating system carries the Kitemark for IoT Secure Digital Applications.



## **SECURED BY DESIGN**

SBD is the official police security initiative. It is owned by the UK Police Service and focusses on crime prevention through innovative security design. SBD works with industry bodies and test houses to create high level security standards. Many of our cycle locks are SBD approved.



## **IN-HOUSE TESTING**

Our in-house testing procedures are aligned to the highest security standards and testing guidelines set by Sold Secure and Secured By Design.

# CONTENTS

<b>INTRODUCTION</b>	<b>2</b>
<b>ACCREDITATIONS</b>	<b>3</b>
<b>SOLD SECURE</b>	<b>4</b>
<b>SQUIRE AMBASSADORS</b>	<b>6</b>
<b>STRONGHOLD® D16 MAX</b>	<b>8</b>
<b>STRONGHOLD®</b>	<b>10</b>
<b>CHAINLOK™</b>	<b>12</b>
<b>STRAPLOK™ 35/850</b>	<b>14</b>
<b>INIGMA™ SMART LOCKS</b>	<b>16</b>
<b>CAFE BIKE LOCKS</b>	<b>18</b>
<b>PADLOCK &amp; CHAIN SETS</b>	<b>22</b>
<b>GROUND &amp; WALL ANCHORS</b>	<b>24</b>
<b>D-LOCKS</b>	<b>26</b>
<b>STRONGLOOP™</b>	<b>28</b>
<b>FOLDING LOCKS</b>	<b>30</b>
<b>CHAIN LOCKS</b>	<b>32</b>
<b>CABLE LOCKS</b>	<b>34</b>
<b>SECURITY CABLE KITS</b>	<b>38</b>
<b>GARAGE DEFENDERS</b>	<b>40</b>
<b>GENERAL SECURITY</b>	<b>42</b>

# ***SOLD SECURE INDEPENDENT ATTACK TESTING***

Sold Secure are the UK's premier independent testing and certification house, dedicated to reducing the risk of crime by the assessment of security products through manual attack.

Products which have been satisfactorily assessed will display a Sold Secure Approved quality mark giving assurance that the bicycle lock is up to the task.

Many bicycle insurance providers insist on the use of Sold Secure Approved products within their policy terms and conditions.

Squire offer a wide range of premium Sold Secure Approved bicycle locks suitable for use At Home or On-The-Go, toughness guaranteed for added peace of mind.

The 4 levels of Sold Secure Approved bicycle accreditations are outlined in the table to the right. This details typical attack duration times as well as tools and methods used.

# ***SOLD SECURE***



# SOLD SECURE CYCLE GRADES EXPLAINED

Helping you choose the right lock for your cycle.



## SOLD SECURE PEDAL CYCLE BRONZE

Ideal if you leave your pedal cycle for a short time in a low risk area like a cafe.

Typically lightweight and easy to carry.



## SOLD SECURE PEDAL CYCLE SILVER

Ideal for lower value pedal cycles left in a medium risk area like your local town centre.

Often the minimum grade insurers ask for when insuring a lower value cycle.



## SOLD SECURE PEDAL CYCLE GOLD

Best if you have a high value pedal cycle that you keep in a high-risk area.

Typically the minimum grade insurers ask for when insuring higher value pedal cycles.



## SOLD SECURE PEDAL CYCLE DIAMOND

Our highest grade aimed at very high value pedal cycles kept in very high-risk areas.

This grade of approval is designed to resist determined cycle thieves.



## SOLD SECURE POWERED CYCLE GOLD

A high level of protection for your powered cycle (e-bike etc.)

Robust locks with a high level of resistance.



## SOLD SECURE POWERED CYCLE DIAMOND

Our highest level of security for powered cycles.

Great if you're looking for an extra level of security.

Tested with angle grinders.

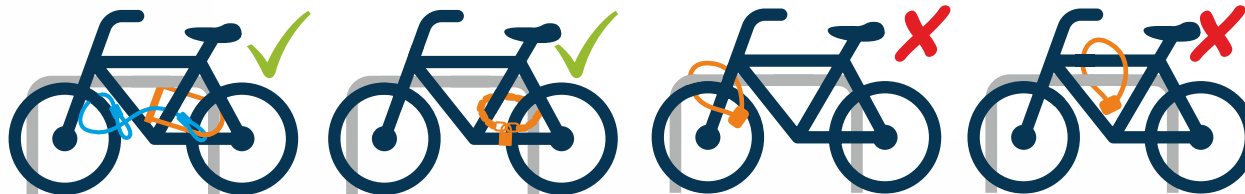

## How to lock your bike correctly

- ✓ Consider using two different Sold Secure approved locks.
- ✓ Lock the frame together with a wheel to the stand.
- ✓ Do not just lock the wheel to the frame or stand.

## **PROUDLY SUPPORTING OUR BIKE LOCK AMBASSADORS**

World record breakers, professional athletes, presenters and content creators, our team of Squire ambassadors are testament to our 'toughness guaranteed' spirit. They will be putting our products to the ultimate test on the international stage with the added peace of mind that their bikes are safely secured both At Home and On-The-Go!

# **SCOTTY LAUGHLAND**

Nationality: UK

Professional Mountain Bike Athlete, Presenter and Content Creator from Scotland. Former DH World Cup and EWS racer now documenting his epic trail rides, bike builds and product test videos via a successful range of social media channels.



# AMBASSADORS

# MARTHA GILL

Nationality: UK

Professional Mountain Biker competing globally on the Crankworx circuit. Martha finished second in the overall queen of Crankworx standings and was the winner on the breakthrough rider award in the 2023 season!



# NICK SANDERS MBE

Nationality: UK

The ultimate adventurer on two-wheels! Fastest man to circumnavigate the globe by motorcycle. Has ridden around the world seven times, breaking two world records!



# **SQUIRE STRONGHOLD® D16 MAX** **MAXIMUM SECURITY** **ANTI-ANGLE GRINDER D-LOCK**

# **STRONGHOLD®**

An ultra-tough bicycle D-Lock which delivers extreme resistance against dedicated angle grinder attacks!

This formidable bike lock is reinforced with additional anti-angle grinder armouring material, proven to defeat multiple angle grinder discs! It features a heavy-duty 16mm boron hardened steel shackle encased in a tough TPE moulding, and a robust 25mm thick hardened steel high-security lock body to deliver cutting-edge defence against bike theft.

The **Stronghold® D16 MAX** is secured using a precision engineered high-security 6-pin key cylinder, including anti-drill, anti-pick and anti-bump technology with over 500,000 possible key differs. This restricted section key system comes complete with a personal key card to prevent unauthorised copying to provide an additional layer of security.

Independently tested, the **Stronghold® D16 MAX** easily surpasses the ultimate Sold Secure Powered Cycle Diamond rating, the highest level of security for powered cycles! This rigorous attack test includes multiple heavy-duty tools and techniques including pry bars, bolt croppers and high-powered portable angle grinders.

The **Stronghold® D16 MAX**. Maximum anti-angle grinder security for all high-end bicycles, e-bikes and e-cargo bikes.

# **D16 MAX**





## **STRONGHOLD® D16 MAX**

### **MAXIMUM SECURITY ANTI-ANGLE GRINDER D-LOCK**

- Featuring highly effective angle grinder resistant armouring material
- Sold Secure Powered Cycle Diamond Approved
- 6-Pin high-security cylinder, 500,000+ key differs
- Restricted section key system
- 2x Keys and personal key card included
- Internal locking dimensions: W-94mm H-218mm
- External lock dimensions: W-150mm H-300mm
- Weight: 2.84kg
- Made in Britain



**10+**  
SECURITY  
RATING



# ***THE SQUIRE STRONGHOLD® RANGE TAKES BICYCLE SECURITY TO THE HIGHEST SOLD SECURE STANDARDS***

**Stronghold®** is universally recognised as our most trusted maximum security brand. It symbolises our 240-year heritage and stands for the very best in British made locks. Tested and approved to the highest Sold Secure Diamond and Gold standards.

- High security **Stronghold®** D16/230 D-Lock, Integrated Chain Lock and compact Folding Lock
- Sold Secure Pedal Cycle Diamond / Gold Approved and Secured by Design
- Ultra-secure restricted section key system with personal key card which prevents unauthorised duplication of keys
- Precision CNC machined solid steel
- Over 500,000 key differs
- Recommended for e-bikes and all high-end bicycles
- Made in Britain

# ***STRONGHOLD®***





## STRONGHOLD® D16/230

### HIGH SECURITY D-LOCK

- 16mm Hardened boron steel shackle
- Hardened steel lock body
- 6 Pin cylinder, over 500,000 differs
- Restricted key system, personal key card to prevent unauthorised copying
- Sold Secure Pedal Cycle Diamond Approved
- Weight: 2.26kg

**10+**  
SECURITY  
RATING



## STRONGHOLD® IC/850

### INTEGRATED CHAIN LOCK

- 10mm Square hardened alloy steel chain
- 850mm in length
- Integrated lock body with hardened steel body
- 6 Pin cylinder, over 500,000 differs
- Restricted key system, personal key card to prevent unauthorised copying
- Sold Secure Pedal Cycle Diamond Approved
- Weight: 2.04kg

**10+**  
SECURITY  
RATING



## STRONGHOLD® FL/850

### FOLDING LOCK

- Compact, easy to carry
- 5mm Hardened boron steel links
- Comes with compact holster, carrying bracket included
- Lock is secured in holster with strap
- 6 Pin cylinder, over 500,000 differs
- Restricted key system, personal key card to prevent unauthorised copying
- Sold Secure Pedal Cycle Gold Approved
- Weight: 3.26kg

**10**  
SECURITY  
RATING



## CHAINLOK™ 10, OUR DIAMOND LEVEL WEARABLE BIKE LOCK

Constructed from heavy-duty 10mm hardened square alloy steel chain, wrapped in a stylish neoprene cover that is both comfortable to wear and kind to your bike frame.

Featuring a unique patented linear pin locking mechanism for easy operation, the dimple key slot system operates without the need for turning, opening with the push of a button to release the lock for quick and easy use.

The stylish neoprene cover is comfortable to wear and kind to your bike frame with the adjustable extender strap allowing for user flexibility, **designed to be worn around the waist when riding.**

Highly resistant to attack and **Sold Secure Pedal Cycle Diamond Approved**, ideal for locking all premium bicycles including e-bikes and e-cargo bikes.

Also available in a lightweight 8mm hardened square alloy steel chain version. The **Chainlok™ 8** is Sold Secure Pedal Cycle Silver Approved.

Connect multiple **Chainlok™** bike locks together to extend the reach of the lock when securing additional bikes.

# CHAINLOK™



## CHAINLOK™ 10

### HIGH SECURITY WEARABLE LOCK

- Sold Secure Pedal Cycle Diamond and Powered Cycle Gold
- Squire Rating 10
- Hardened alloy steel chain
- Neoprene sleeve, comfortable to wear and won't scratch bicycle paint work
- Unique patented linear pin tumbler locking mechanism
- Chain link diameter 10mm
- Chain length 850mm
- Extender strap included
- x2 Keys
- Weight: 2.29kg

**10**  
SECURITY  
RATING



## CHAINLOK™ 8

### HIGH SECURITY WEARABLE LOCK

- Sold Secure Pedal Cycle Silver Approved
- Squire Rating 9
- Hardened alloy steel chain
- Neoprene sleeve, comfortable to wear and won't scratch bicycle paint work
- Unique patented linear pin tumbler locking mechanism
- Chain link diameter 8mm
- Chain length 850mm
- Extender strap included
- x2 Keys
- Weight: 1.79kg

**9**  
SECURITY  
RATING



# STRAPLOK™ 35/850 AN ULTRA-CONVENIENT & LIGHTWEIGHT SOLUTION FOR KEEPING YOUR BIKE SECURE WHEN YOU'RE ON-THE-GO.

Featuring a unique patented linear pin locking mechanism for easy operation, the dimple key system operates without the need for turning, opening with the push of a button to release the lock for quick and easy use. Constructed from a multi-cable high tensile steel core, resistant to attack and **Sold Secure Silver Approved**.

The stylish neoprene cover is comfortable to wear and kind to your bike frame with the adjustable extender strap allowing for user flexibility, **designed to be worn around the waist when riding.**

Connect multiple Straplok™ 35/850 bike locks together to extend the reach of the lock when securing additional bikes. **Available in 5 vibrant colourways** and also available as a Keyed Alike Twin Pack.

# STRAPLOK™ 35/850



## STRAPLOK™ 35

### HIGH SECURITY WEARABLE LOCK

- Sold Secure Pedal Cycle Silver Approved
- Squire Rating 9/10
- 35mm High tensile steel core resistant to cutting and sawing
- Silicone outer layer with neoprene cover, comfortable to wear and won't scratch your bicycle frame
- Unique linear pin tumbler locking mechanism, patent applied for
- Length 850mm
- Extender strap included
- x2 Keys
- Weight: 1.26kg

**9**  
SECURITY  
RATING





## STRAPLOK™ 35 T

### TWIN PACK

- Straplok 35 Twin Pack
- Two extender straps included
- x4 Keys (Keyed Alike)
- Weight: 2.52kg



**9**  
SECURITY  
RATING



# inigma™ SMART TECHNOLOGY BLUETOOTH BIKE LOCKS

Our super-secure range of smartphone operated bike locks. Featuring one of the world's most secure smart operating systems. The first ever bike locks to achieve the BSI Kitemark for IoT (Residential).

- Key-free smart security
- Smartphone operated via the inigma™ app
- Pair with iOS and Android devices
- Sold Secure Approved
- Maximum security military grade AES-256 bit encryption
- Two BSI Kitemark accreditations - IoT (Residential) - Secure Digital Applications
- Set individual operating schedules with comprehensive audit trails
- Control multiple locks from one smartphone
- Share access to your locks with other users
- Optional automatic unlocking function
- Tested and approved for all weather conditions

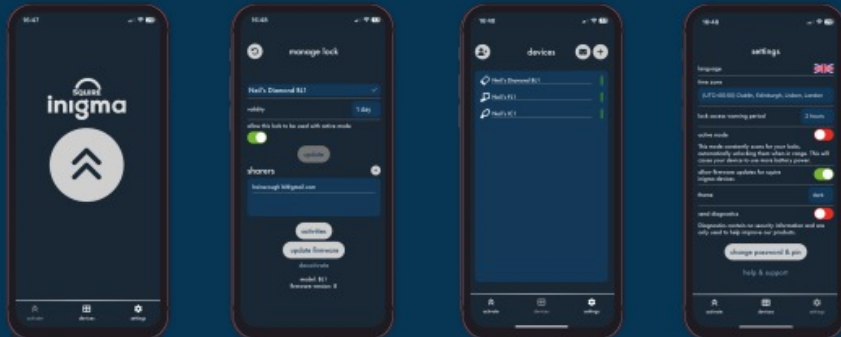

# SQUIRE inigma







## inigma™ Diamond BL1

### HIGH SECURITY D-LOCK

- 12.7mm Hardened boron steel shackle
- Lightweight aluminium lock body with internal armouring
- Impact modified ABS plastic exterior
- Indicator light/wake button
- Integrated release button
- Highest BSI Kitemark Certifications
- Patented
- Sold Secure Pedal Cycle Diamond Approved
- Carrying bracket included
- Weight: 1.44kg

**10+**  
SECURITY  
RATING



## inigma™ IC1

### INTEGRATED CHAIN LOCK

- 8mm Square hardened alloy steel chain
- 800mm Total length
- High quality, durable, protective chain sleeve
- Lightweight aluminium lock body with hardened steel casing
- Impact modified ABS plastic exterior
- Indicator light/wake button
- Integrated release button
- BSI Kitemarks
- Patented
- Sold Secure Pedal Cycle Bronze Approved
- Weight: 1.96kg

**8**  
SECURITY  
RATING



## inigma™ FL1

### FOLDING LOCK

- 5mm Hardened steel links with ABS plastic covering
- 800mm Total length
- Lightweight aluminium lock body with hardened steel casing
- Impact modified ABS plastic exterior
- Compact holster with carrying bracket included
- Indicator light/wake button
- Integrated release button
- BSI Kitemarks
- Patented
- Sold Secure Pedal Cycle Bronze Approved
- Weight: 1.52kg

**8**  
SECURITY  
RATING



## **STRAPLOK™ COMBI 10 - OUR ULTRA-LIGHTWEIGHT BIKE LOCK RANGE, DESIGNED TO DETER THE OPPORTUNIST.**

The **Straplok™ Combi 10** is a lightweight 3-wheel combination bike lock ideal for cyclists looking for key-free convenient bike security.

Ideal compact short-term security for your bike, helmet or accessories, recommended for use in low-risk areas. **Available in 5 vibrant colourways**

The perfect pocket-sized companion on a cafe bike ride, at an mtb trail centre, on a gravel ride, bikepacking adventure or weekend road cycling club meet.

# **CAFE BIKE LOCKS**





## **STRAPLOK™ COMBI 10**

### **MULTI-USE COMBINATION STRAPLOK**

- Squire Rating 3/10
- 3-wheel recodable combination
- 10mm Stainless steel core
- Length 450mm
- Ideal for short term security in low-risk areas
- Weight: 0.10kg

**3**  
**SECURITY**  
**RATING**

**STRAPLOK™ COMBI 10 BLUE**  
**STRAPLOK™ COMBI 10 GREEN**  
**STRAPLOK™ COMBI 10 PINK**  
**STRAPLOK™ COMBI 10 YELLOW**

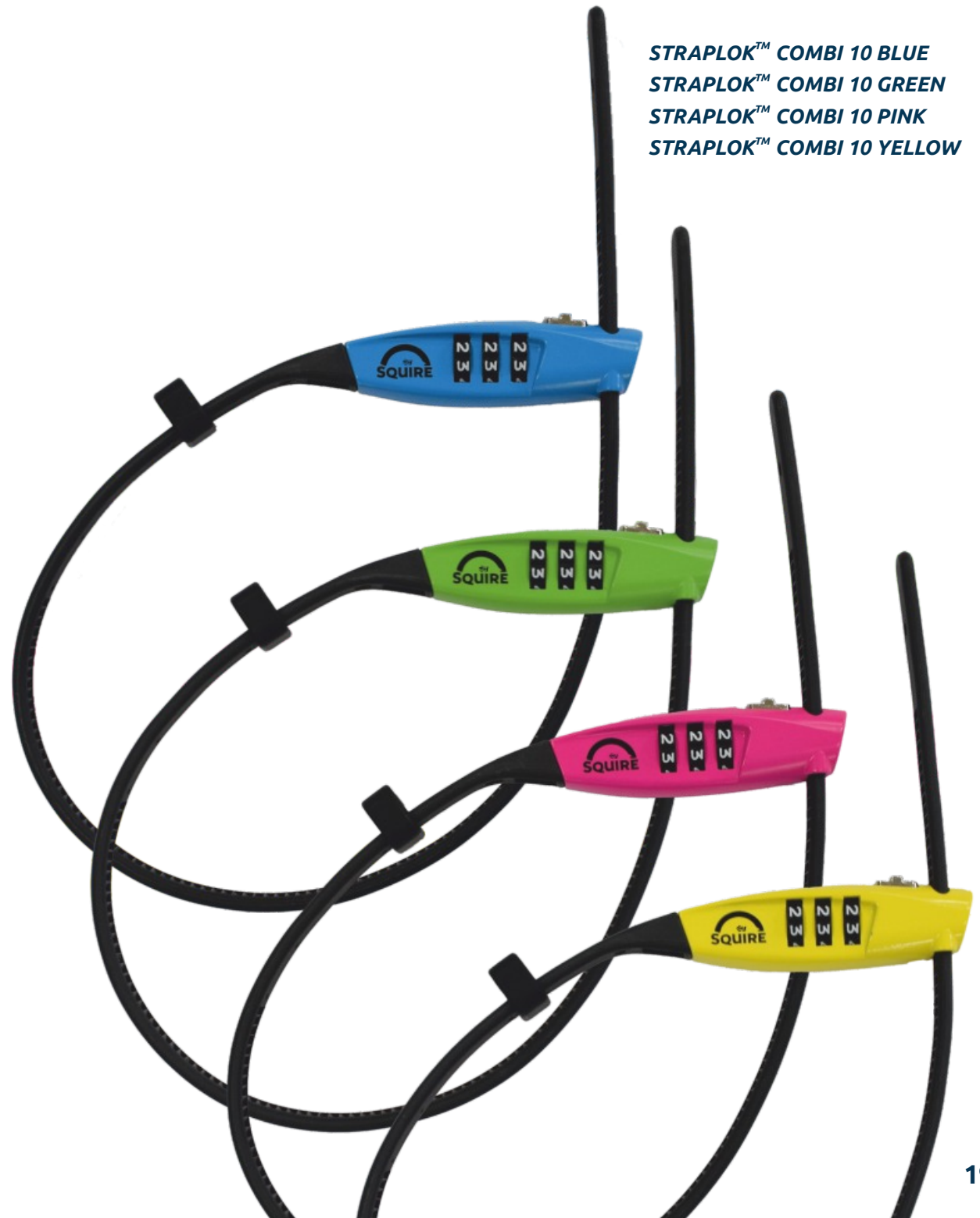

## **STRAPLOK™ 10/400 AND RETRAC MAX POCKET SIZED SECURITY**

Our lightweight **Straplok™ 10/400** features a unique patented linear pin locking mechanism and stainless steel core. Simply insert the key and push the release button for quick and easy access. Also available as a Keyed Alike Triple Pack.

The **Retrac Max** is a compact and lightweight multi-use retractable cable lock. Offering 900mm in length, this pocket-sized 4-wheel combination cable bike lock is ideal for short term use in low-risk areas. The quick release and rewind push buttons enable the PVC coated cable to be stored neatly within the lock body.

# **CAFE BIKE LOCKS**





## **STRAPLOK™ 10/400**

### **MULTI-USE STRAPLOK**

- Squire Rating 3/10
- 10mm Stainless steel core
- Length 450mm
- Ideal for short term security in low-risk areas
- Unique linear pin tumbler locking mechanism, patent applied for
- x2 Keys
- Weight 0.04kg

**3**  
**SECURITY**  
**RATING**

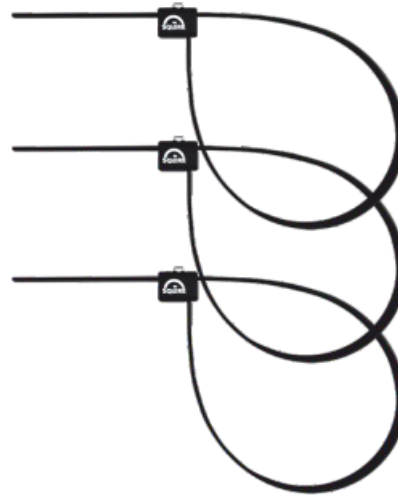

## **STRAPLOK™ 10/400TR**

### **TRIPLE PACK**

- x6 Keys (Keyed Alike)
- Weight: 0.12kg

**3**  
**SECURITY**  
**RATING**



## **RETRAC MAX**

### **MULTI-USE RETRACTABLE CABLE LOCK**

- Squire Rating 3/10
- 900mm PVC coated steel cable
- 4 Wheels, 10,000 possible combinations
- Quick release push button rewind
- Ideal for short term security in low-risk areas
- Weight: 0.09kg

**2**  
**SECURITY**  
**RATING**

# SQUIRE PADLOCK & CHAIN SETS, THE ULTIMATE IN BICYCLE HOME SECURITY

For the ultimate in cycle security, you need a Padlock & Chain Set you can trust. Our ultra tough range of Sold Secure Approved Padlock & Chain Sets are rigorously attack tested to the highest in-house and independent standards. Available in both key and combination lock models featuring hardened alloy steel chains with high quality, durable, protective chain sleeves. Toughness guaranteed bicycle security At Home when paired with a Squire, Sold Secure Approved, Ground or Wall Anchor.



## JUGGERNAUT & JUGGERNAUT XL

**65MM CLOSED SHACKLE PADLOCK  
14MM HARDENED ALLOY  
STEEL CHAIN**

- 14mm Diameter hardened alloy steel chain
- Available in two lengths 1200mm and 2000mm (Juggernaut XL)
- 65mm Solid hardened steel body padlock with 12.7mm hardened boron steel shackle
- 6 Pin tumbler anti-pick lock mechanism over 250,000 key differs
- Anti-corrosion finish
- Sold Secure Pedal Cycle Diamond Approved
- Weight: 6.4kg and 9.33kg (XL)

# PADLOCK & CHAIN SETS

**10+**  
SECURITY  
RATING





## IMMENSE & IMMENSE XL

**50MM CLOSED SHACKLE PADLOCK  
10MM HARDENED ALLOY  
STEEL CHAIN**

- 10mm Diameter hardened alloy steel chain
- Available in two lengths 1200mm and 2000mm (Immense XL)
- 50mm Solid hardened steel body padlock with 10mm hardened boron steel shackle
- 6 Pin tumbler anti-pick lock mechanism over 250,000 key differs
- Anti-corrosion finish
- Sold Secure Pedal Cycle Diamond Approved
- Weight: 4.34kg and 6.22kg (XL)

**10<sup>+</sup>**  
SECURITY  
RATING



## WARRIOR

**55MM CLOSED SHACKLE PADLOCK  
10MM HARDENED ALLOY  
STEEL CHAIN**

- 10mm Diameter hardened alloy steel chain
- 1200mm Length chain
- 34mm Armoured steel lock body padlock with 10mm hardened boron steel closed shackle
- 5 Pin cylinder lock mechanism
- Sold Secure Bicycle Gold Approved
- Weight: 4.05kg

**9**  
SECURITY  
RATING



## WARRIOR COMBI

**55MM CLOSED SHACKLE PADLOCK  
10MM HARDENED ALLOY  
STEEL CHAIN**

- 10mm Diameter hardened alloy steel chain
- 1200mm Length chain
- 32mm Armoured steel lock body padlock with 10mm hardened boron steel closed shackle
- 4 Wheel combination - 10,000 combinations
- Sold Secure Pedal Cycle Gold Approved
- Weight: 4.07kg

**9**  
SECURITY  
RATING



## VIKING

**70MM DISCUS PADLOCK  
8MM HARDENED ALLOY  
STEEL CHAIN**

- 8mm Diameter hardened alloy steel chain
- 1200mm Length chain
- Stainless steel padlock with anti-drill plate
- 9.5mm Hardened steel shackle
- 5 Pin tumbler lock mechanism
- Sold Secure Pedal Cycle Silver Approved
- Weight: 2.43kg

**8**  
SECURITY  
RATING



## ***LOCK YOUR BIKE WITH CONFIDENCE WITH A SOLD SECURE APPROVED GROUND OR WALL ANCHOR***

Our ultra tough hardened steel range of high security Ground & Wall Anchors offer added peace of mind when securing your bike at home. Designed to be fixed to brick or concrete and supplied with security fixing bolts including tamper proof steel ball inserts. Pair your Ground or Wall Anchor with a Squire Padlock & Chain Set for the ultimate in Sold Secure Approved home security



# ***GROUND & WALL ANCHORS***







## EVEREST

### GROUND/WALL ANCHOR

- For use indoors and outdoors
- Single bridge anchor
- Hardened steel 5mm construction
- Can be used in brick or concrete
- Can be used as a ground or wall anchor
- Supplied with four security fixing bolts, steel ball inserts
- Blue powder coated finish
- Fits chains up to 19mm
- Sold Secure Pedal Cycle Diamond Approved
- Weight: 1.86kg

**10**  
SECURITY  
RATING



## SUMMIT

### GROUND/WALL ANCHOR

- For use indoors and outdoors
- Can be used in brick and concrete
- Can be used as a ground or wall anchor
- Hardened steel 5mm construction
- Blue powder coated finish
- Supplied with two security fixing bolts, steel ball inserts
- Fits chains up to 10mm
- Sold Secure Pedal Cycle Gold Approved
- Weight: 0.84kg

**8**  
SECURITY  
RATING



## PEAK

### GROUND/WALL ANCHOR

- For use indoors and outdoors
- Can be used in brick and concrete
- Can be used as a ground or wall anchor
- Hardened steel 5mm construction
- Blue powder coated finish
- Supplied with two security fixing bolts, steel ball inserts
- Fits chains up to 8mm
- Sold Secure Pedal Cycle Silver Approved
- Weight: 0.4kg

**5**  
SECURITY  
RATING



## ***GIVE YOUR BIKE THE SECURITY IT DESERVES***

Give your bike the security it deserves with our wide range of ultra-tough Sold Secure Approved D-Locks. Thoroughly attack tested to deter even the most determined bike thief to give you added peace of mind. Secure your wheels and accessories when you pair your D-Lock with a Squire security cable.

# ***D-LOCKS***





## MATTERHORN™ 230/10C

### D-LOCK AND SECURITY CABLE PACK

- Sold Secure Pedal Cycle Diamond Approved (D-Lock Only)
- Squire Rating 10/10
- 14mm Diameter hardened steel shackle
- Double locking and deadlocking
- 230mm Shackle clearance
- 1800mm x 10mm Security cable included
- Bike frame carrying bracket included
- x2 Keys
- Weight: 1.36kg (D-Lock only)



## MATTERHORN™ COMPACT /10C

### D-LOCK AND SECURITY CABLE PACK

- Sold Secure Pedal Cycle Diamond Approved
- Squire Rating 10/10
- 14mm Diameter hardened steel shackle
- Double locking and deadlocking
- 140mm Shackle clearance
- 1800mm x 10mm Security cable included
- Bike frame carrying bracket included
- x2 Keys
- Weight: 1.10kg (D-Lock only)



## NEVIS™ 230/10C

### D-LOCK AND SECURITY CABLE PACK

- Sold Secure Pedal Cycle Silver Approved (D-Lock Only)
- Squire Rating 9/10
- 13mm Diameter hardened steel shackle
- Double locking and deadlocking
- 230mm Shackle clearance
- 1800mm x 10mm Security cable included
- Bike frame carrying bracket included
- x2 Keys
- Weight: 1.14kg (D-Lock only)



**EXTEND THE LOCKING RANGE OF YOUR SQUIRE  
D-LOCK WITH A TOUGH AND SECURE  
STRONGLOOP™ LASSO CHAIN.**

The 8mm hardened alloy steel chain also features a heavy-duty hardened steel loop-end which enables full use of the chain length when locking your bike and components to street furniture, or when locking multiple bikes together. The Squire Strongloop™ is available in 2 convenient chain lengths.

**Sold Secure Pedal Cycle Silver Approved**, this heavy-duty lasso chain can be used with D-Locks up to 14mm in shackle diameter.

**STRONGLOOP™**





## **STRONGLOOP™ J4**

**8MM HARDENED ALLOY STEEL CHAIN  
WITH LOOP-END - LENGTH 1200MM**

- 8mm Hardened steel chain
- 1200mm length
- Sold Secure Pedal Cycle Silver Approved
- Loop end
- Weight: 2.42kg

**8**  
SECURITY  
RATING



## **STRONGLOOP™ J3**

**8MM HARDENED ALLOY STEEL CHAIN  
WITH LOOP-END - LENGTH 915MM**

- 8mm Hardened steel chain
- 915mm length
- Sold Secure Pedal Cycle Silver Approved
- Loop end
- Weight: 1.88kg

**8**  
SECURITY  
RATING

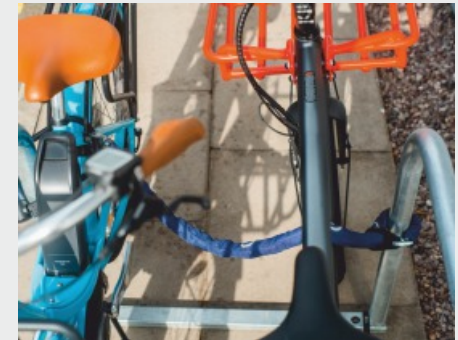
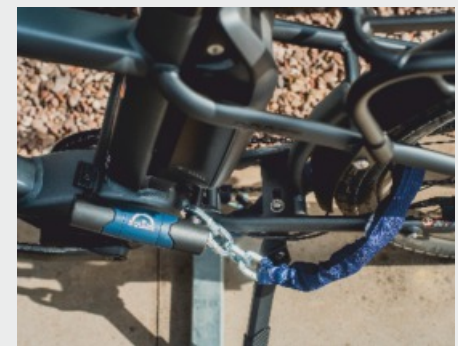



***SQUIRE FOLDA LOCKS OFFER TOUGHNESS GUARANTEED,  
ULTRA COMPACT SECURITY, FOR EVERY CYCLIST***

Our robust key operated **FOLDA** folding locks are available in two convenient sizes, both featuring weather resistant hardened steel arms that fold neatly away for easy storage, as well as universal carrying brackets that mount directly to your bike.



***FOLDING LOCKS***



In carrying bracket



folded



open



## **FOLDA FL/850**

### **850MM FOLDING LOCK**

- Compact, easy to carry, easy to use
- Hardened steel links
- Disc tumbler lock mechanism
- Carrying bracket included
- Lightweight, ways just 780g

**7**  
SECURITY  
RATING



## **FOLDA MINI FL/690**

### **690MM FOLDING LOCK**

- Extra compact, easy to carry, easy to use
- Hardened steel links
- Disc tumbler lock mechanism
- Carrying bracket included
- Lightweight, ways just 500g

**6**  
SECURITY  
RATING

# **LIGHTWEIGHT, TOUGH AND FLEXIBLE SECURITY WITH OUR INTEGRATED CHAIN AND CABLE KILDA BIKE LOCKS**

Innovative in design and available in both key and combination models.

The Kilda 6/900 integrated chain lock is constructed from a tough but lightweight 6mm diameter hardened steel chain and is protected with a durable scratch resistant chain sleeve cover.

Our wide range of key and combination Kilda cable bike locks are available in a variety of lengths and thicknesses. Constructed from high-tensile steel, these tough bike cable locks are ideal for securing your bike for short periods in low-risk areas, or for layering your bike security when locking wheels or accessories.

The Kilda 15/1800 is a long bike cable lock at 1.8 metres in length, with a tough 15mm diameter steel cable core wrapped in a protective weatherproof sleeve. A great option for locking multiple bikes together or for use as an additional security measure when transporting your bikes on a car bike rack.

# **KILDA CHAIN LOCKS**







## **KILDA CN 6/900**

### **KEY OPERATED INTEGRATED LOCK AND CHAIN**

- 6mm Diameter chain links
- Length 900mm
- Hardened steel chain
- Comes with 3 keys
- Protective dust cover on keyway
- Weight: 0.60kg

**5**  
SECURITY  
RATING



## **KILDA COMBI CN 6/900**

### **INTEGRATED COMBINATION LOCK AND CHAIN**

- 6mm Diameter chain links
- Length 900mm
- Hardened steel chain
- 4 Wheels, 10,000 possible combinations
- Fully recodable
- Weight: 0.60kg

**5**  
SECURITY  
RATING



## **TOUGH AND LIGHTWEIGHT KILDA CABLE LOCKS IDEAL FOR ON-THE-GO SHORT STAY SECURITY**

Our key and combination Kilda cable locks offer a compact, lightweight and tough security solution ideal for on-the-go rides in low risk areas.

# **KILDA CABLE LOCKS**



### **KILDA 15/1800**

**KEY OPERATED CABLE LOCK  
15MM DIAMETER**

- 15mm Diameter cable
- Length 1800mm
- Disc tumbler lock mechanism
- Protective dust cover on keyway
- Comes with 3 keys
- Carrying bracket included
- Weight: 0.72kg

**5**  
**SECURITY  
RATING**





## **KILDA** **12/1800**

**KEY OPERATED CABLE LOCK**  
**12MM DIAMETER**

- 12mm Diameter cable
- Length 1800mm
- Disc tumbler lock mechanism
- Protective dust cover on keyway
- Comes with 3 keys
- Carrying bracket included
- Weight: 0.57kg

**4**  
**SECURITY**  
**RATING**



## **KILDA** **10/1800**

**KEY OPERATED CABLE LOCK**  
**10MM DIAMETER**

- 10mm Diameter cable
- Length 1800mm
- Disc tumbler lock mechanism
- Protective dust cover on keyway
- Comes with 3 keys
- Carrying bracket included
- Weight: 0.46kg

**3**  
**SECURITY**  
**RATING**



## **KILDA** **10/600**

**KEY OPERATED CABLE LOCK**  
**10MM DIAMETER**

- 10mm Diameter cable
- Length 600mm
- Disc tumbler lock mechanism
- Protective dust cover on keyway
- Comes with 3 keys
- Carrying bracket included
- Weight: 0.22kg

**3**  
**SECURITY**  
**RATING**



# KILDA COMBI CABLES





## ***KILDA COMBI 12/1800***

***COMBINATION CABLE LOCK  
12MM DIAMETER***

- 12mm Diameter cable
- Length 1800mm
- 4 Wheels, 10,000 possible combinations
- Fully recodable
- Carrying bracket included
- Weight: 0.60kg

**4**  
**SECURITY  
RATING**



## ***KILDA COMBI 10/1800***

***COMBINATION CABLE LOCK  
10MM DIAMETER***

- 10mm Diameter cable
- Length 1800mm
- 4 Wheels, 10,000 possible combinations
- Fully recodable
- Carrying bracket included
- Weight: 0.49kg

**3**  
**SECURITY  
RATING**



## ***KILDA COMBI 10/600***

***COMBINATION CABLE LOCK  
10MM DIAMETER***

- 10mm Diameter cable
- Length 600mm
- 4 Wheels, 10,000 possible combinations
- Fully recodable
- Carrying bracket included
- Weight: 0.25kg

**3**  
**SECURITY  
RATING**

## ***SECURE YOUR BIKES, WHEELS AND ACCESSORIES WITH A SECURITY CABLE KIT***

Extra-long security cable kits providing additional security when locking wheels, accessories or multiple bikes together. These multi-strand high tensile 12mm diameter steel cables are available in three different lengths. Featuring heavy duty, weather resistant protective covers and two looped ends to maximise usability.

Each security cable kit includes our best selling ultra-reliable CP50 4-wheel combination padlock, with an 8mm hardened steel shackle and handy push button opening.

Ideal for use At Home or On-The-Go, in your workshop or when transporting your fleet of bikes to the trail.

# ***SECURITY CABLE KITS***





## **COMBI 12C** **SECURITY CABLE KIT**

- 12mm Diameter multi-strand, high tensile steel cable
- Length 1800mm
- Heavy duty weather resistant cover
- CP50 4-wheel combination padlock
- 8mm Hardened steel shackle
- Die cast alloy body cover
- Push button opening

**4**  
**SECURITY**  
**RATING**



## **COMBI 12C/5M** **SECURITY CABLE KIT**

- 12mm Diameter multi-strand, high tensile steel cable
- Length 5000mm
- Heavy duty weather resistant cover
- CP50 4-wheel combination padlock
- 8mm Hardened steel shackle
- Die cast alloy body cover
- Push button opening

**4**  
**SECURITY**  
**RATING**



## **COMBI 12C/10M** **SECURITY CABLE KIT**

- 12mm Diameter multi-strand, high tensile steel cable
- Length 10000mm
- Heavy duty weather resistant cover
- CP50 4-wheel combination padlock
- 8mm Hardened steel shackle
- Die cast alloy body cover
- Push button opening

**4**  
**SECURITY**  
**RATING**

## ***SQUIRE GARAGE DEFENDERS OFFERING FRONT LINE SECURITY FOR UP AND OVER GARAGE DOORS***

Stop opportunist thieves in their tracks with our Sold Secure Domestic Bronze Approved and Secured By Design accredited Garage Defender range. They not only add a great visual deterrent but also offer high level security with their hardened steel construction. Designed to be fixed to concrete and supplied with security fixing bolts.



# ***GARAGE DEFENDERS***





## **GARAGE DEFENDER 5**

- Extra security for up and over garage doors
- High security hardened steel construction
- 5 Pin tumbler lock mechanism
- Surface mounted, all in one, integrated product
- Tilt action arm locks into place to prevent garage door from being opened
- Supplied with all fixings
- Once opened, drive straight over, no removal needed
- Sold Secure Domestic Bronze Approved

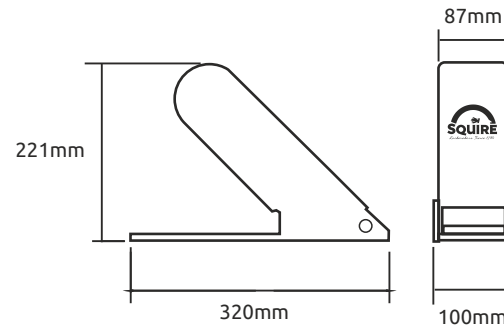

## **GARAGE DEFENDER 4**

- Unit locks onto a solid steel base with padlock
- Simple ground fitting in front of garage door with expandable security raw bolts included
- Blue powder coated finish
- Heavy construction
- Full fitting instructions included
- Sold Secure Domestic Bronze Approved

**10**  
SECURITY  
RATING



**10**  
SECURITY  
RATING

## **EXTERNAL SECURITY SORTED WITH SQUIRE'S RANGE OF KEY AND COMBINATION PADLOCKS**

Upgrade your gate, shed and garage security with our wide range of trusted key and combination padlocks. Tested to the highest security standards at Squire's in-house test facility. Manufactured to the finest tolerances to ensure performance that you can rely on.



# **GENERAL SECURITY**



CP40 CP40/2.5 CP50 CP50/2.5

## CP40 & CP50 COMBINATION PADLOCKS

- Hardened steel shackles - CP40 range 6mm, CP50 range 8mm
- Standard shackle and long shackle variants available
- Double locking
- 4 Wheels 10,000 combinations
- Fully recodable
- Die cast alloy body cover
- Push button opening
- New patented design

**5**  
SECURITY  
RATING  
CP50

**4**  
SECURITY  
RATING  
CP40



LN4 LN3

## LION RANGE LN3 & LN4

### SOLID BRASS PREMIUM GRADE PADLOCKS

- Hardened steel shackles - LN3 5.5mm, LN4 6mm
- Double locking
- Solid brass lock body
- Pin tumbler lock mechanism
- Superior duty security - excellent economic choice

**3**  
SECURITY  
RATING  
LN4

**2**  
SECURITY  
RATING  
LN3



ATL42S

## ALL TERRAIN ATL42S

### ALL WEATHER PADLOCKS

- Stainless steel 6mm shackles
- Solid brass lock body
- All weather, protective body cover for extra resistance to the environment
- Pin tumbler cylinder

**3**  
SECURITY  
RATING

## ***UPGRADE YOUR EXTERNAL SECURITY WITH SQUIRE'S RANGE OF TOUGHNESS GUARANTEED LOCKING BOLTS, HASPS AND STAPLES***

The COMBI-BOLT™ 4 is a unique combination locking bolt that acts as a convenient alternative to a standard hasp and staple. It is available in blue and brushed chrome finishes and has four wheels offering 10,000 possible combinations. Ideal for use on sheds, gates and garages.



# ***GENERAL SECURITY***



## COMBI-BOLT™ 4

### UNIQUE RECODABLE LOCKING BOLT

- Die cast lock body
- Steel bolt
- 4 Wheels for 10,000 combinations
- No Keys to Lose
- One handed operation
- Security screws included in pack
- High pick resistance
- Patented
- Replaces a padlock and hasp & staple

**4**  
SECURITY  
RATING



## KEYBOLT™

### WEATHERPROOF LOCKING BOLT

- Steel lock body and bolt encased in a weatherproof cover
- Steel components
- 4 Lever lock mechanism
- Lever lock mechanism gives excellent reliability outdoors
- Can be used indoors or outdoors

**4**  
SECURITY  
RATING



## NO.6H

### HASP AND STAPLE

- Hardened steel hasp and staple
- Hardened steel construction with anti-corrosion finish
- Coach bolt fixings for added security
- Concealed fixings
- Can be used on single or double doors

**6**  
SECURITY  
RATING



[www.squirelocks.co.uk](http://www.squirelocks.co.uk)

Tel: +44 (0)1902 308050

[info@henry-squire.co.uk](mailto:info@henry-squire.co.uk)



@squirelocks @squirebikelocks

Henry Squire & Sons Limited,  
Hilton Cross Business Park,  
Cannock Road, Featherstone,  
Wolverhampton, WV10 7QZ



  
**240** YEARS  
OF LOCKMAKING EXCELLENCE